

RS-107

FEATURES:

- * Sink Size: 21 5/8" x 17 3/4" x 3 1/2"
- * Material: Blanca Carera
- * Counter Top Sink
- * Hidden Drain System Included
- * Recommended Drain: DS-001
- * Pre-drilled Hole For Faucet
- * For Use With Standard Pop Up Drain
- * Warranty: One Year Limited Warranty

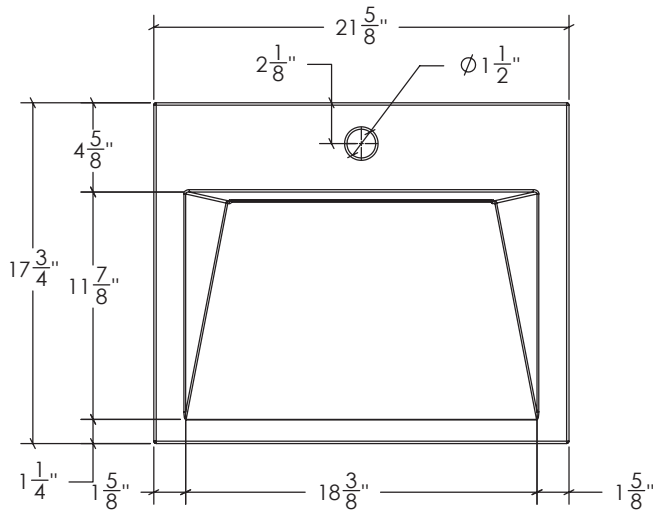

TOP VIEW

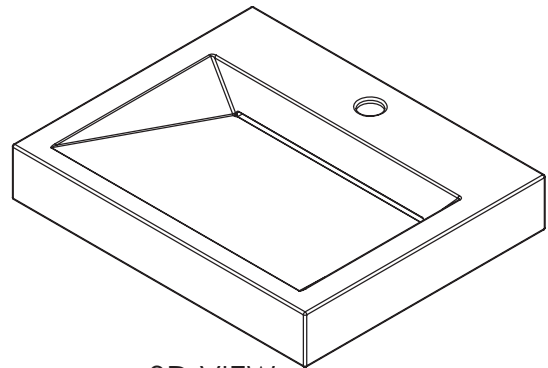

3D VIEW

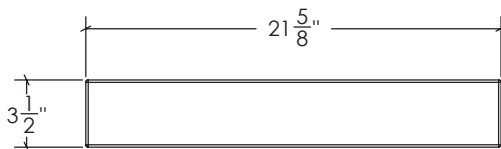

FRONT VIEW

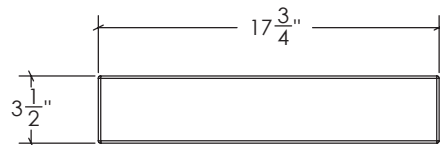

SIDE VIEW

JOB INFORMATION:

Job Name _____

Date Specified _____

Contractor _____

* Specifications and drawings provided on this sheet are for illustration only. Cantrio Concepts will not be held responsible for cutouts made without the actual product or product template.